

SSP GENERAL DATA (SSP 270, SSP300, SSP 360)

14" WELL SIZE

Models

SSP 270 (SP 270 G m³/h)

SSP 300 (SP 300 G m³/h)

SSP 360 (SP 360 G m³/h)

Operating Condition

Flow Rate, Q - 24 - 430 m³/h

Head, H - Max. 410 meter

Material

Diffuser - Cast Iron

Impeller - Bronze



V14 PUMPS



PUMP RANGE

Type	SSP 270	SSP 300	SSP360
Cast Iron	+	+	+
DIN Connection	DIN 175	DIN 175	DIN 175

MOTOR RANGE

Motor Output 1kW]	22	26	30	37	45	55	75	93	110	132	147	170	190	220
Three Phase	+	+	+	+	+	+	+	+	+	+	+	+	+	+
Rewindable Motor	+	+	+	+	+	+	+	+	+	+	+	+	+	+
Steel: AISI 304	+	+	+	+	+	+	+	+	+	+	+	+	+	+
Steel: AISI 304 & Cast Iron	+	+	+	+	+	+	+	+	+	+	+	+	+	+

Soft starter or auto transformer is recommended above 75 kW, see soft starting. The MMS motors can be operated via frequency converter see Frequency converter operation.

Motors with star-delta are available for all motor sizes.

TYPE KEY

Example SSP 270-2 A	SSP	270	2	A
Type range				
Rated flow in m3/h				
Number of impellers				
Impeller type				

PUMPED LIQUIDS

Clean, thin, non-aggressive liquids without solid particles or fibers.

Maximum sand contents : 50 g/m³

OPERATING CONDITIONS

Flow Rate, Q	:	24-430 m ³ /h
Head, H	:	Maximum 410 m
Operating Pressure	:	Maximum 60 bar
Storage temperature	:	Pump: -20 °C to +60 °C Motor: -20 °C to +70 °C.

Motor	Installation		
	Flow velocity past motor	Vertical	Horizontal
8", 10" & 12"	0.15 m/s	40 °C	40 °C

FEATURES & BENEFITS

PUMP RANGE

The SSP pump range consists of pumps which can deliver a higher pressure or a higher flow compared to the rest of the QF pump range offered by Shakti.

SSP Pumps are semi-axial pumps. They are suitable for applications requiring a flow up to 430 m³/h and a head up to 410 m head.

All pumps are available with an optional number of stages to match any duty point.

PRODUCT FEATURES

Bearings with sand channels

All bearings are constructed in such a way that channels are formed along the shaft enabling sand, if any, to leave the pump with the pumped liquid.

The bearings in SSP Pumps are Octagonal on the inside.

INLET STRAINER (Fig. no. 1)

The inlet strainer prevents particles over a certain size from entering and damaging the pump.

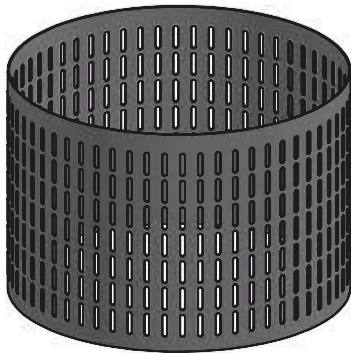

(Fig. no. 1)

PROTECTION AGAINST UP THRUST (Fig. no.2)

The pump range has a screwed connection between the coupling of the pump and the motor shaft ensuring that upthrust in the pump, if any, is transferred to the stop ring of the motor.

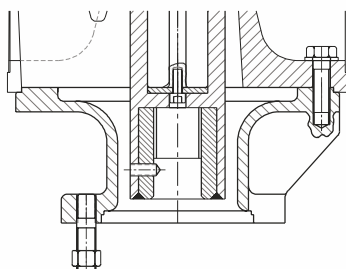

(Fig. no. 2)

VALVE CASING (Fig. no.3)

All pumps are equipped with a reliable non-return valve in the valve casing preventing back flow in connection with pump stoppage.

The valve casing is designed for optimum hydraulic properties to minimize the pressure loss across the Valve and thus contribute to minimizing the total pressure loss of the pump.

Furthermore, the short closing time of the non-return valve means that the risk of destructive water hammer is reduced to a minimum.

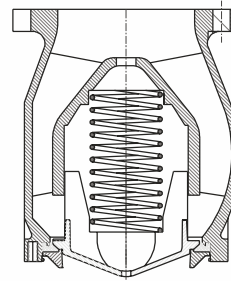

(Fig. no. 3)

NECK RING (Fig. no.4)

All pumps have a replaceable neck ring in each chamber.

This means that the neck ring can be replaced easily in case of wear.



(Fig. no. 4)

PERFORMANCE RANGE

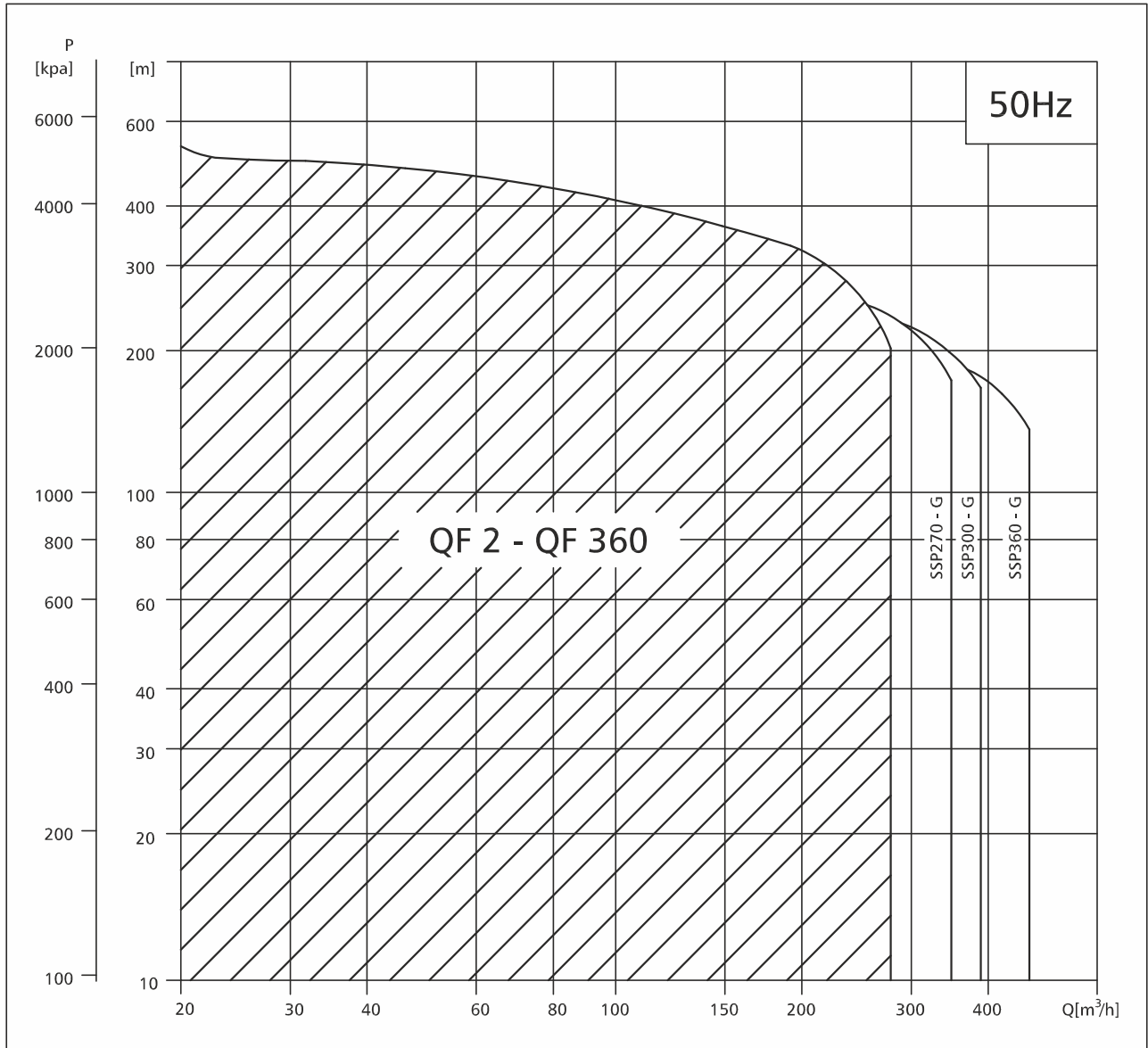

SUBMERSIBLE PUMP SSP-270

MATERIAL SPECIFICATION SSP-270

SR.NO.	DESCRIPTION	MATERIAL	MATERIAL
1	VALVE CASING	CAST IRON	CI-FG-260
1d	BOWL O-RING	RUBBER	NBR
2	VALVE CUP	BRONZE	LBT-2
3	VALVE SEAT	RUBBER	NBR
3a	VALVE SEAT RETAINER	BRONZE	LBT-2
4	TOP CHAMBER	CAST IRON	CI-FG-260
6	TOP BEARING BUSH	BRONZE	LBT-4
7	WEARING RING	BRONZE	LBT-4
8	BEARING BUSH	SS+RUBBER	SS-304+NBR
9	INTER CHAMBER	CAST IRON	CI-FG-260
12	BEARING SLEEVE	STAINLESS STEEL	AISI SS-304
13	IMPELLER	BRONZE	LBT-2
14	SUCTION INTERCONNECTOR	CAST IRON	CI-FG-260
15	STRAINER	STAINLESS STEEL	AISI SS-304
16	SHAFT	STAINLESS STEEL	DUPLEX
18	CABLE GUARD	STAINLESS STEEL	AISI SS-304
24	COUPLING	STAINLESS STEEL	AISI SS-304
35a	STUD	STAINLESS STEEL	AISI SS-304
35b	NUT	STAINLESS STEEL	AISI SS-304
73	SUCTION CASE ADOPTER	CAST IRON	CI-FG-260

SECTIONAL VIEW OF SSP-270 PUMP ASSLY

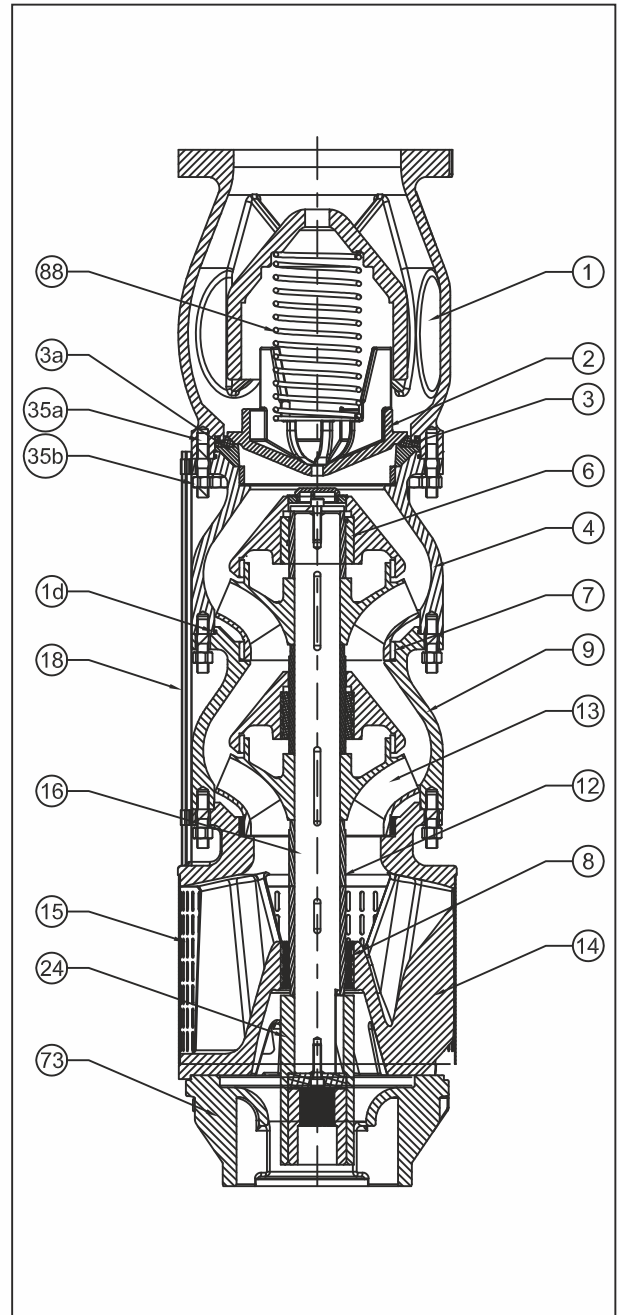

PERFORMANCE CURVE



SUBMERSIBLE PUMP SSP-270

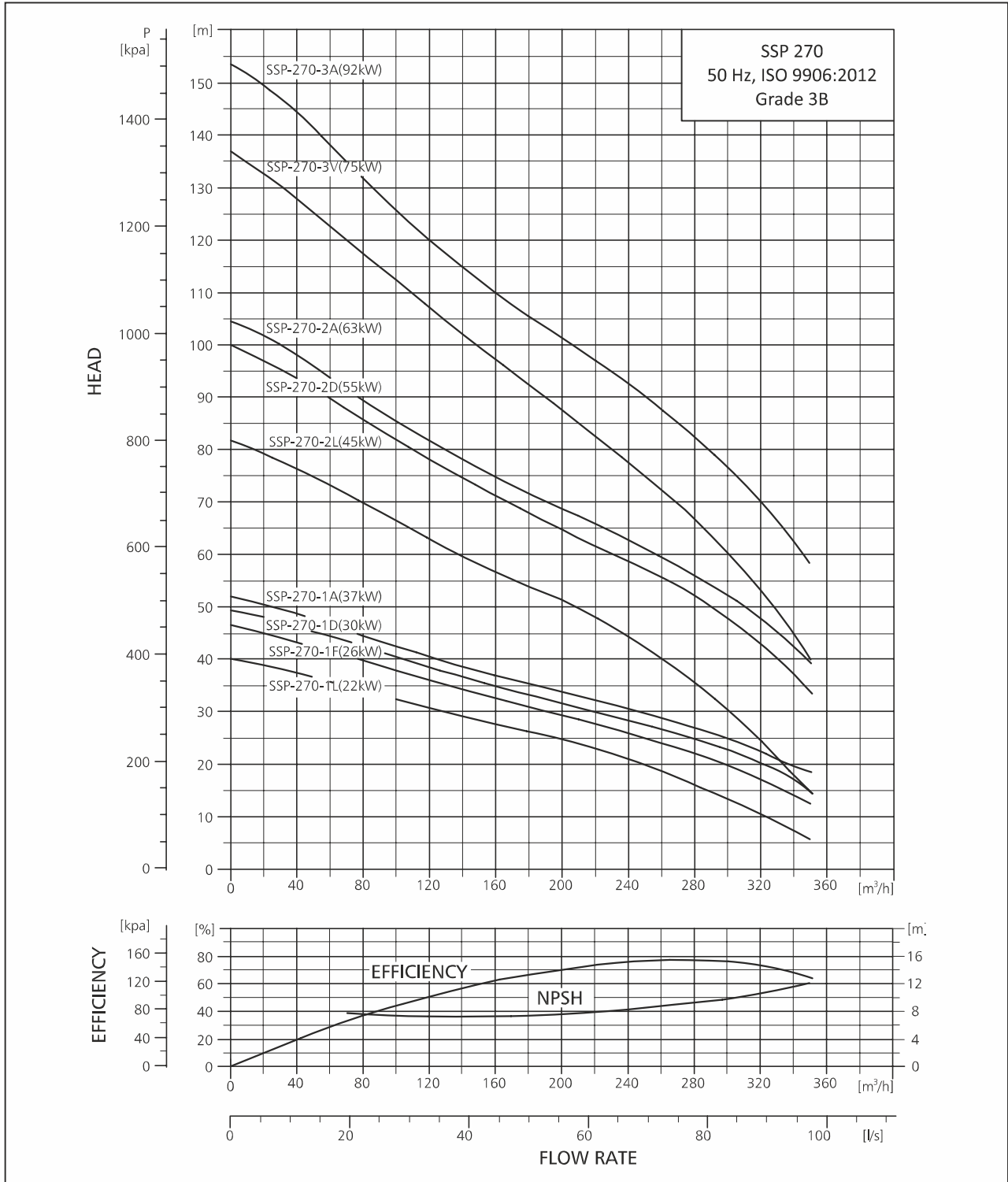

PERFORMANCE CURVE



SUBMERSIBLE PUMP SSP-270

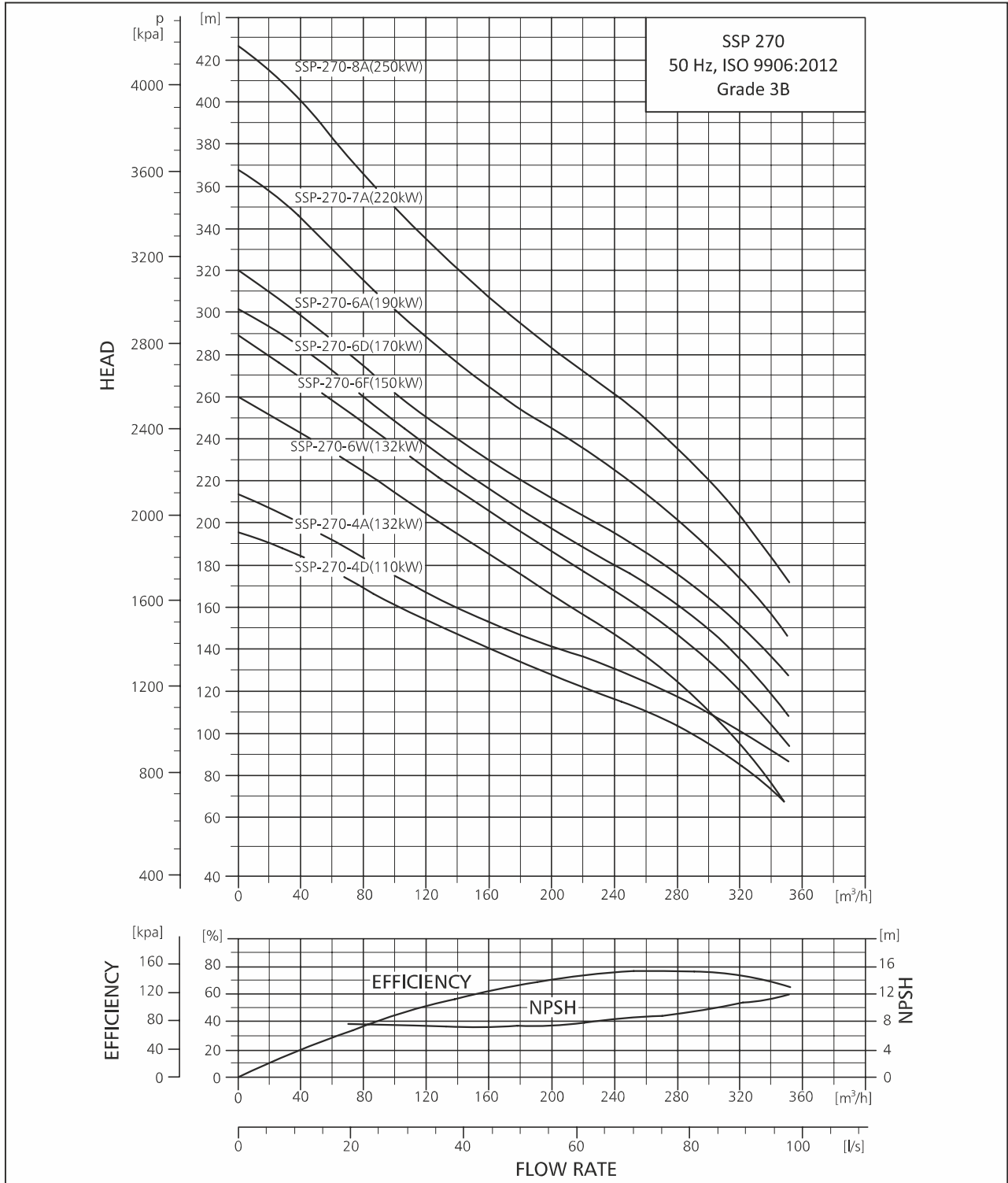

SUBMERSIBLE PUMP SSP-270

DIMENSIONS AND WEIGHTS

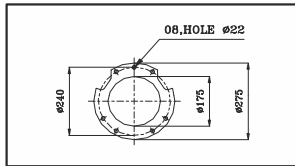
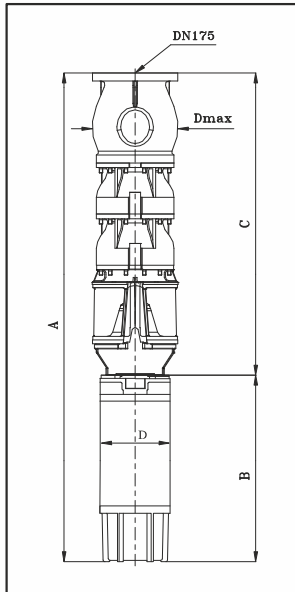

TECHNICAL DATA SSP-270

PUMP TYPE	MOTOR		DIMENSIONS (MM)				NET WEIGHT (KG) PUMPS SET
	TYPE	POWER (kW)	C	B	A	D	
SSP 270-1L	MATSFC8"	22	885	1040	1925	194	266
SSP 270-1F	MATSFC8"	26	885	1140	2025	194	274
SSP 270-1D	MATSFC8"	30	885	1140	2025	194	286
SSP 270-1A	MATSFC8"	37	885	1140	2025	194	296
SSP 270-2L	MATSFC8"	45	1065	1230	2295	194	342
SSP 270-2D	MATSFC8"	55	1065	1340	2405	194	357
SSP 270-2A	MATSFC8"	63	1065	1470	2535	194	383
SSP 270-3V	MATSFC8"	75	1245	1560	2805	194	427
SSP 270-3A	MATSFC8"	93	1245	1740	2985	194	473
SSP 270-4D	MATSF10"	110	1425	1529	2954	235	605
SSP 270-4A	MATSF10"	130	1425	1659	3084	235	655
SSP 270-6W	MATSF10"	130	1785	1659	3444	235	705
SSP 270-6F	MATSF10"	150	1785	1769	3554	235	770
SSP 270-6D	MATSF10"	170	1785	1919	3704	235	890
SSP 270-6A	MATSF10"	185	1785	1919	3704	235	935
SSP 270-7A	MATSF12"	220	1965	1893	3858	286	1010
SSP 270-8A	MATSF12"	250	2145	1893	4038	286	1100

Dmax (6",8",10" and 12") :290mm

PERFORMANCE TABLE SSP 270

SSP 270					DISCHARGE (Q)										
					m ³ /h		0	40	80	120	160	200	240	280	320
					l/min.		0	668	1336	2004	2672	3340	4008	4676	5344
MODEL	MATERIAL				MOTOR RATING		TOTAL HEAD IN (m)								
	6" joining	8" joining	10" joining	12" joining	[kW]	[HP]									
SSP270-1 L	9000010964	-	-	-	22	30	41	38	34	30	28	25	21	17	10
SSP270-1F	9000010961	-	-	-	26	35	47	44	40	37	33	30	27	23	18
SSP270-1D	9000010962	-	-	-	30	40	49	47	43	39	35	32	29	25	20
SSP270-1A	9000010963	-	-	-	37	50	52	49	45	41	37	33	30	27	23
SSP270-2L	-	9000018456	-	-	45	60	80	76	69	62	56	50	44	35	24
SSP270-2D	-	9000010965	-	-	55	75	98	92	85	77	70	63	58	51	42
SSP270-2A	-	9000010966	-	-	63	85	103	96	88	80	73	68	62	55	46
SSP270-3V	-	9000010967	-	-	75	100	136	128	117	106	96	87	73	67	51
SSP270-3A	-	9000010968	-	-	92	125	155	145	133	121	111	102	93	83	71
SSP270-4D	-	-	9000010969	-	110	150	197	185	170	155	141	129	117	104	87
SSP270-4A	-	-	9000010970	-	132	177	207	194	178	162	149	137	126	113	96
SSP270-6W	-	-	9000010971	-	132	177	253	238	219	199	181	162	143	119	90
SSP270-6F	-	-	9000010972	-	147	197	283	266	242	220	199	181	164	144	115
SSP270-6D	-	-	9000010973	-	185	252	296	277	255	234	213	194	177	158	132
SSP270-6A	-	-	9000010974	-	185	252	311	290	267	243	223	205	189	170	146
SSP270-7A	-	-	-	9000010975	220	295	362	338	310	283	260	239	221	197	169
SSP270-8A	-	-	-	9000010976	250	335	414	387	355	324	297	274	252	226	193

This Performance Table is Approximate as a Performance Curve
 Technical Change without notice

PERFORMANCE CURVE



SUBMERSIBLE PUMP SSP-270

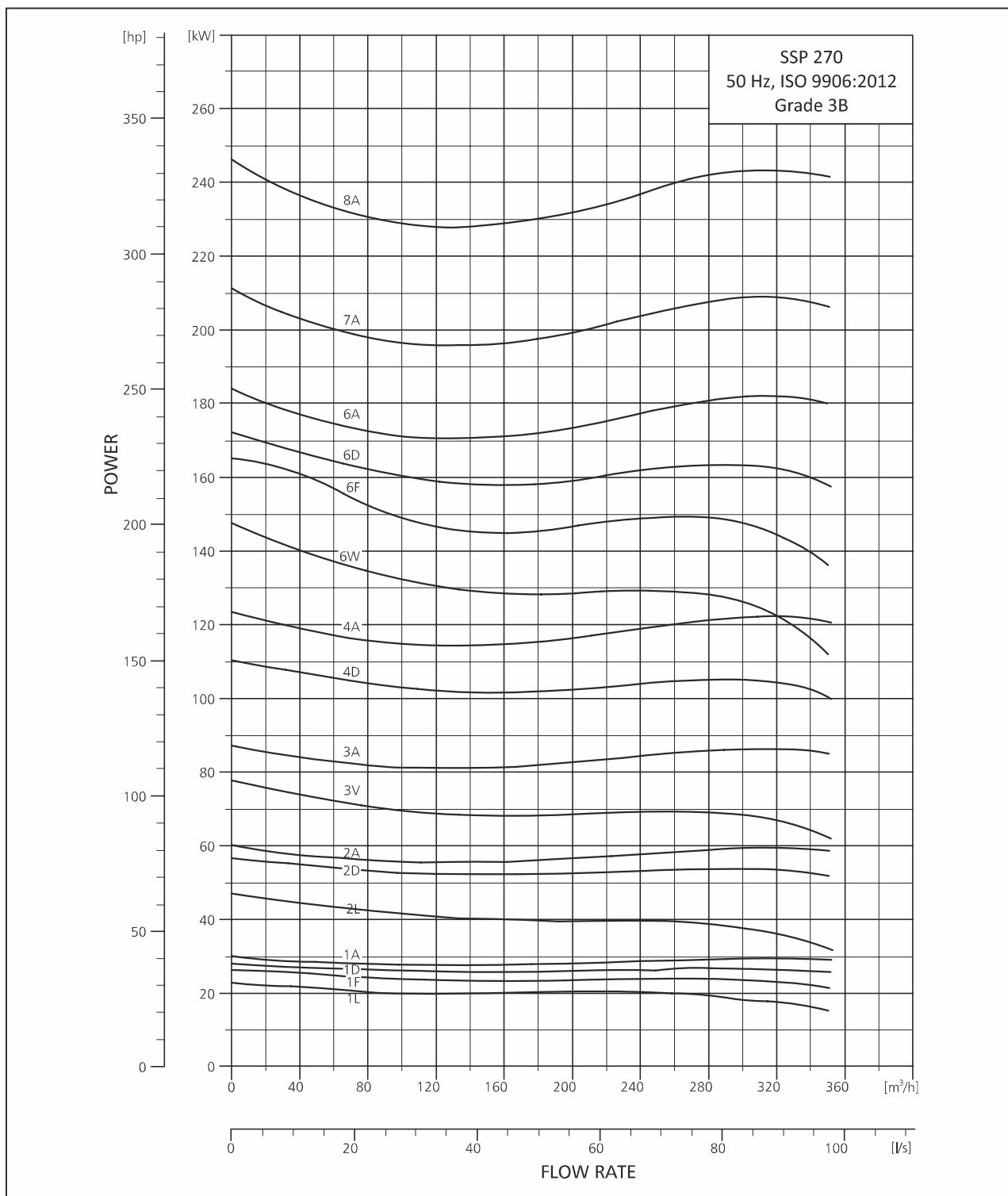

PERFORMANCE CURVE



SUBMERSIBLE PUMP SSP-300

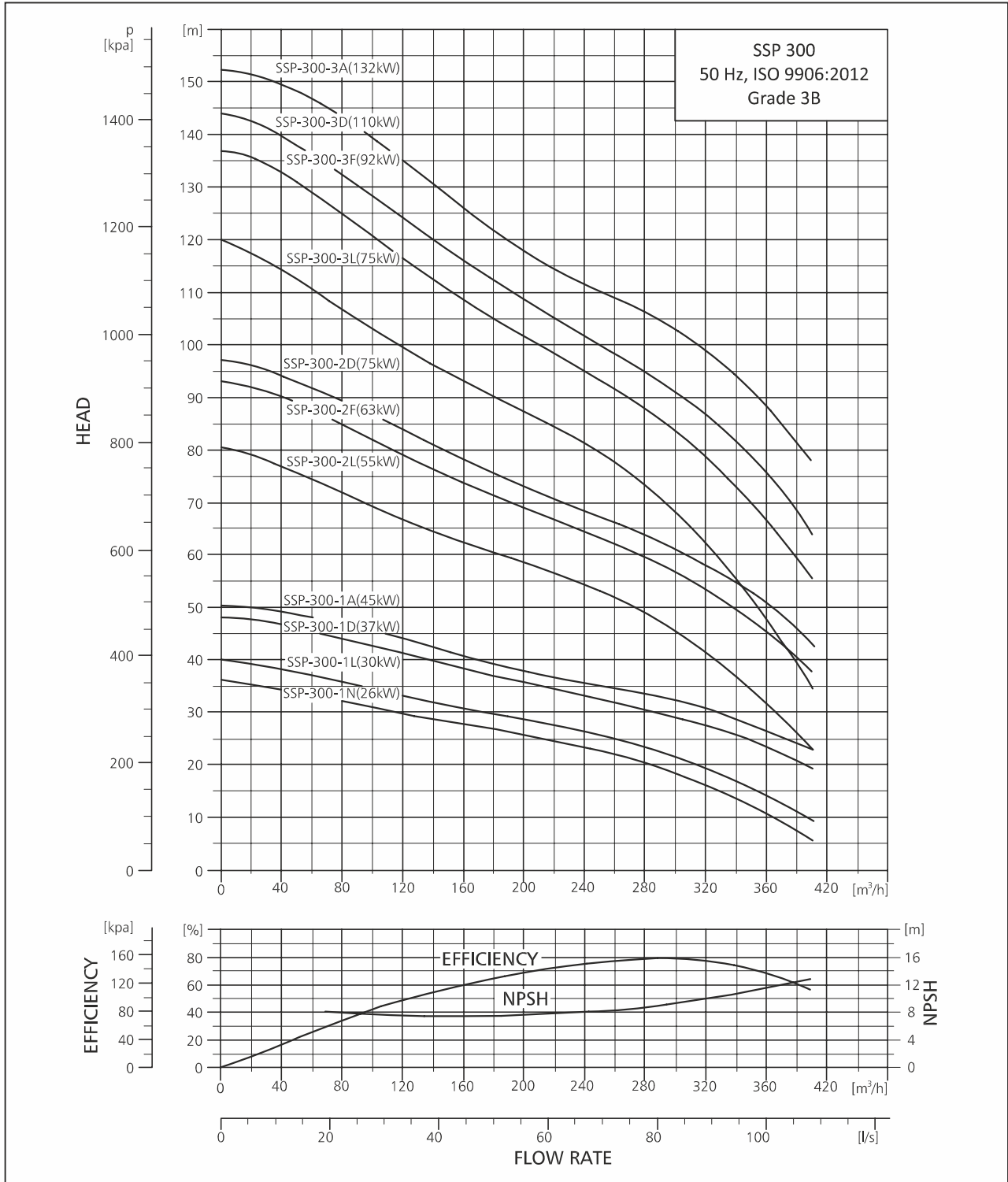

PERFORMANCE CURVE



SUBMERSIBLE PUMP SSP-300

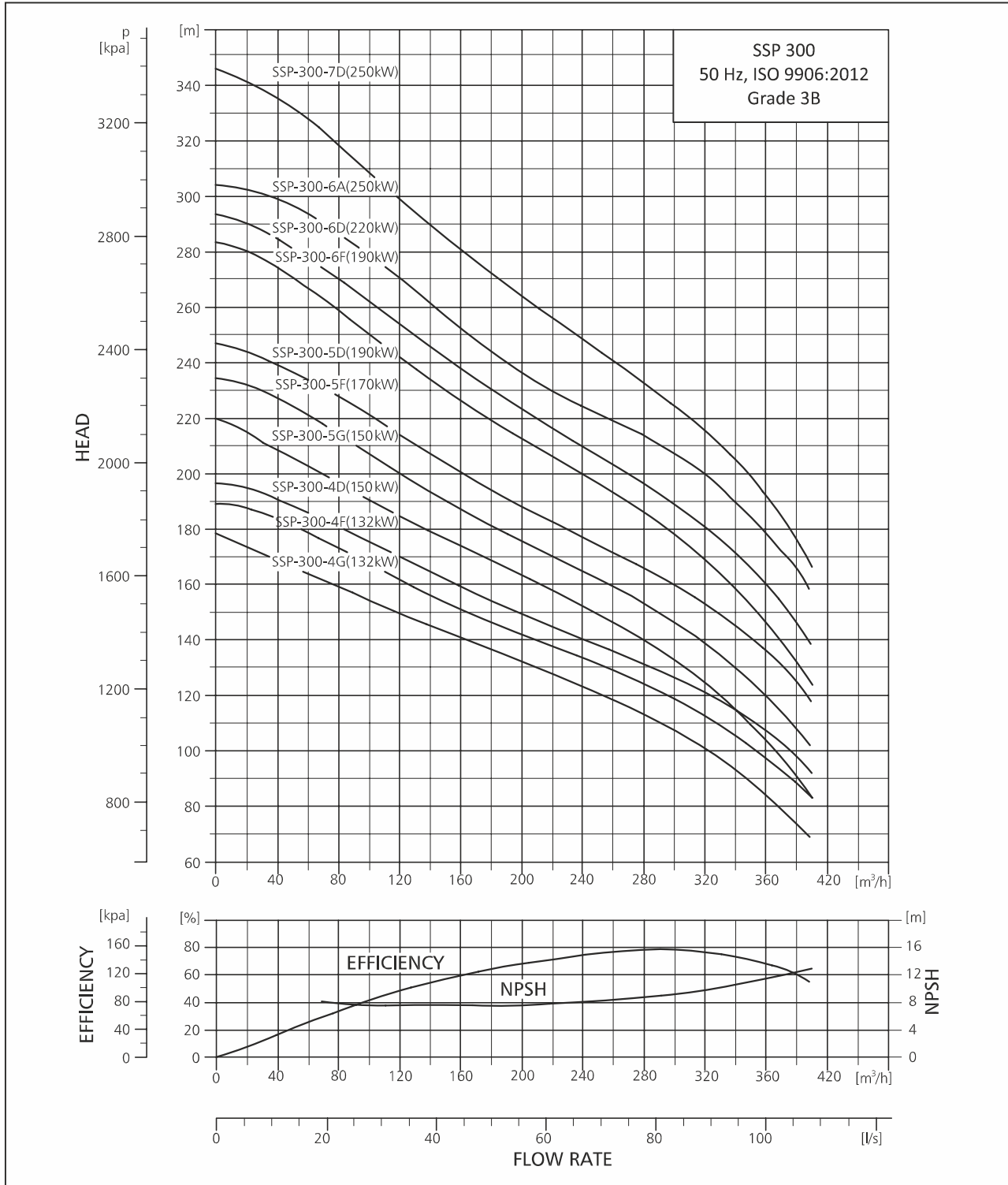

TECHNICAL DATA



SUBMERSIBLE PUMP SSP-300

DIMENSIONS AND WEIGHTS

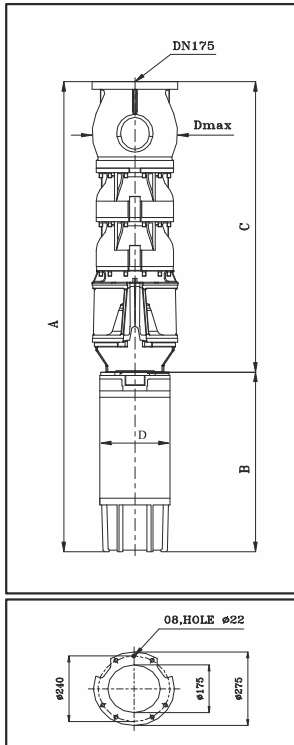

TECHNICAL DATA SSP-300

PUMP TYPE	MOTOR		DIMENSIONS (MM)				NET WEIGHT (KG) PUMPS SET
	TYPE	POWER (kW)	C	B	A	D	
SSP300-1N	MATSF8"	22	885	1140	2025	194	266
SSP300-1L	MATSF8"	30	885	1140	2025	194	286
SSP300-1D	MATSF8"	37	885	1140	2025	194	296
SSP300-1A	MATSF8"	45	885	1230	2115	194	317
SSP300-2L	MATSF8"	55	1065	1340	2405	194	357
SSP300-2F	MATSF8"	63	1065	1470	2535	194	383
SSP300-2D	MATSF8"	75	1065	1560	2625	194	402
SSP300-3L	MATSF8"	75	1245	1560	2805	194	427
SSP300-3F	MATSF8"	93	1245	1740	2985	194	473
SSP300-3D	MATSF10"	110	1245	1529	2774	235	580
SSP300-3A	MATSF10"	130	1245	1659	2904	235	630
SSP300-4G	MATSF10"	130	1425	1659	3084	235	655
SSP300-4F	MATSF10"	132	1425	1659	3084	235	655
SSP300-4D	MATSF10"	150	1425	1769	3194	235	720
SSP300-5G	MATSF10"	150	1605	1769	3374	235	745
SSP300-5F	MATSF10"	170	1605	1919	3524	235	865
SSP300-5D	MATSF10"	185	1605	1919	3524	235	910
SSP300-6F	MATSF10"	185	1785	1919	3704	235	935
SSP300-6D	MATSF12"	220	1785	1893	3678	286	985
SSP300-6A	MATSF12"	250	1785	1893	3678	286	1060
SSP300-7D	MATSF12"	250	1965	1893	3858	286	1085

Dmax (6",8",10" and 12"):290mm

PERFORMANCE TABLE SSP 300

SSP 300					DISCHARGE (Q)											
					m ³ /h		0	40	80	120	160	200	240	280	320	360
					l/min.		0	668	1336	2004	2672	3340	4008	4676	5344	6012
MODEL	MATERIAL				MOTOR RATING		TOTAL HEAD IN (m)									
	6" joining	8" joining	10" joining	12" joining	[kW]	[HP]	37	34	32	29	28	26	23	21	16	10
SSP300-1 N	9000010977	-	-	-	26	35	37	34	32	29	28	26	23	21	16	10
SSP300-1L	9000010978	-	-	-	30	40	38	35	33	30	29	27	24	22	17	11
SSP300-1D	9000014266	-	-	-	37	50	48	46	44	41	39	36	34	31	28	24
SSP300-1A	-	9000010980	-	-	45	60	49	48	46	44	41	38	36	33	30	26
SSP300-2L	-	9000010981	-	-	55	75	80	76	71	66	62	58	54	49	41	31
SSP300-2F	-	9000010982	-	-	63	85	92	89	84	78	73	68	64	59	53	45
SSP300-2D	-	9000010983	-	-	75	100	93	90	85	79	74	69	65	60	54	46
SSP300-3L	-	9000010984	-	-	75	100	119	114	106	98	93	87	81	72	62	47
SSP300-3F	-	9000010985	-	-	93	125	138	134	126	118	110	103	96	89	80	68
SSP300-3D	-	-	9000010986	-	110	150	145	140	133	125	117	109	103	99	87	76
SSP300-3A	-	-	9000013929	-	132	177	149	146	140	131	123	115	108	102	95	85
SSP300-4G	-	-	9000010988	-	132	177	173	165	155	146	137	128	119	109	96	79
SSP300-4F	-	-	9000010989	-	132	177	185	179	168	157	147	138	129	120	108	92
SSP300-4D	-	-	9000010990	-	147	197	193	187	178	167	156	146	137	128	118	102
SSP300-5G	-	-	9000010991	-	147	197	216	204	193	181	170	159	148	135	120	98
SSP300-5F	-	-	9000010992	-	170	252	231	224	211	197	184	172	162	150	135	116
SSP300-5D	-	-	9000010993	-	185	252	242	234	222	209	195	183	172	161	148	136
SSP300-6F	-	-	9000010994	-	185	252	276	268	252	236	230	206	194	180	162	139
SSP300-6D	-	-	-	9000010995	220	295	290	280	266	250	234	219	206	193	177	156
SSP300-6A	-	-	-	9000010996	250	335	297	292	279	263	245	230	217	206	192	171
SSP300-7D	-	-	-	9000010997	250	335	337	327	310	291	272	256	240	224	206	182

This Performance Table is Approximate as a Performance Curve
 Technical Change without notice

PERFORMANCE CURVE



SUBMERSIBLE PUMP SSP-300

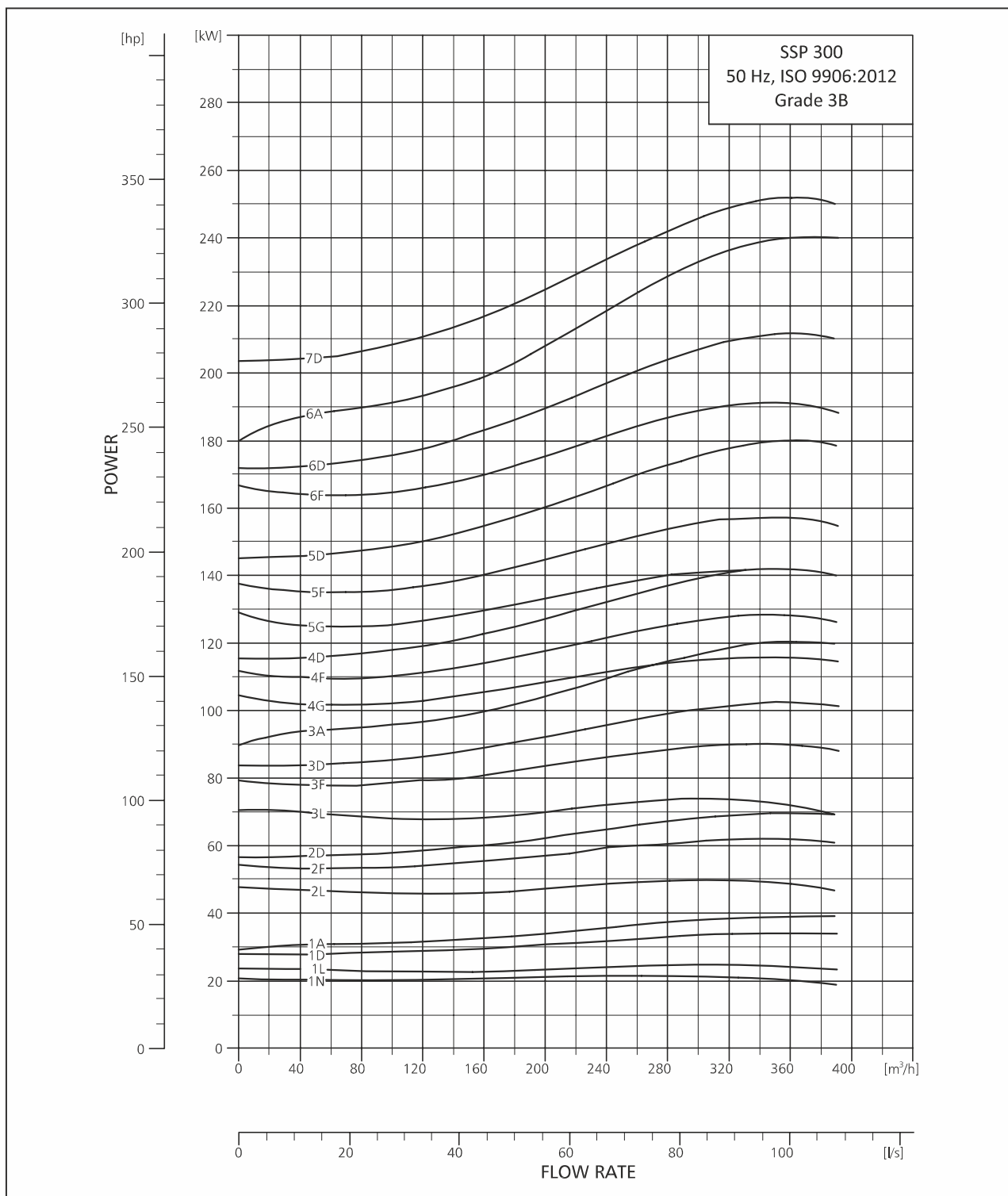

PERFORMANCE CURVE



SUBMERSIBLE PUMP SSP-360

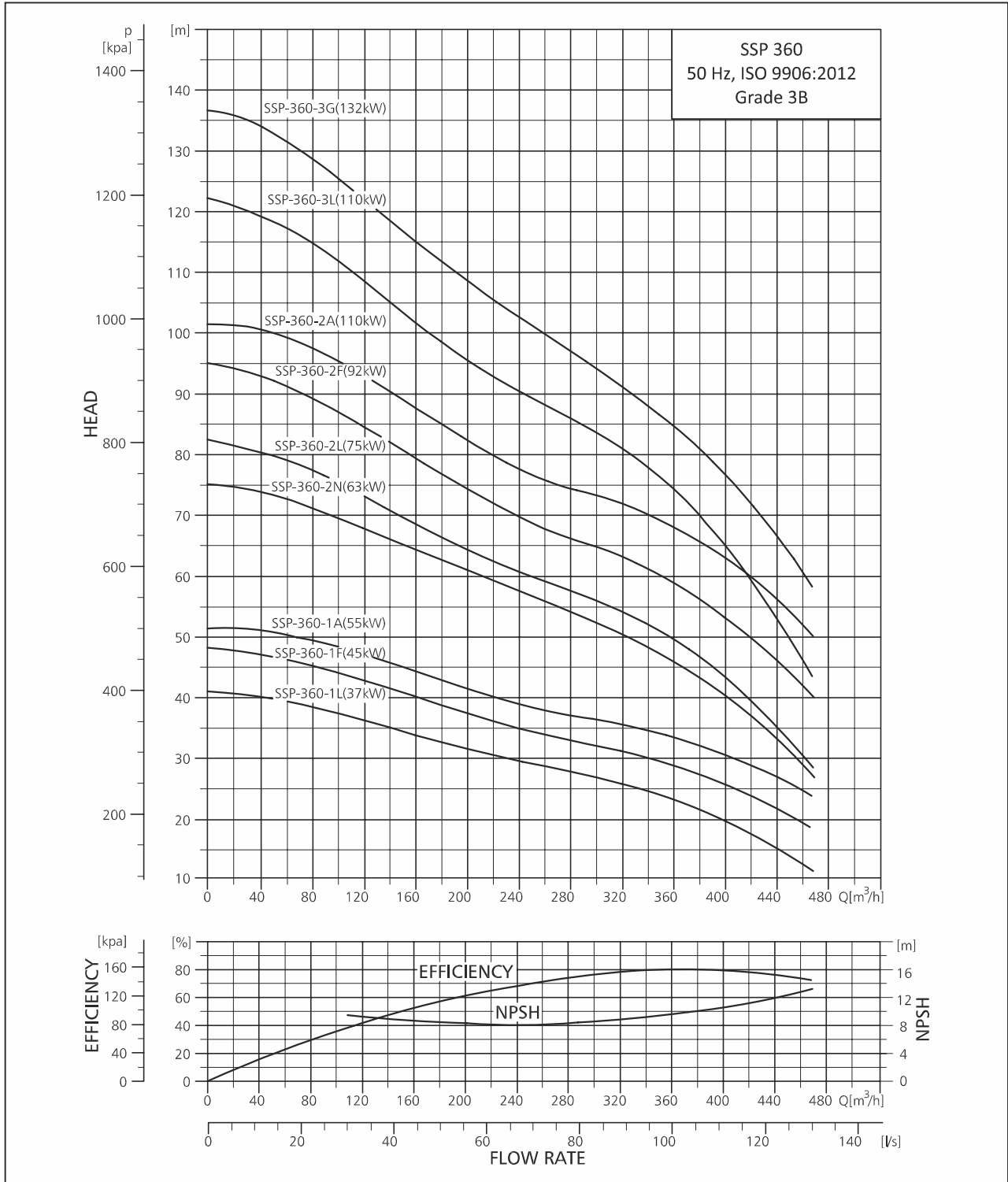

PERFORMANCE CURVE



SUBMERSIBLE PUMP SSP-360

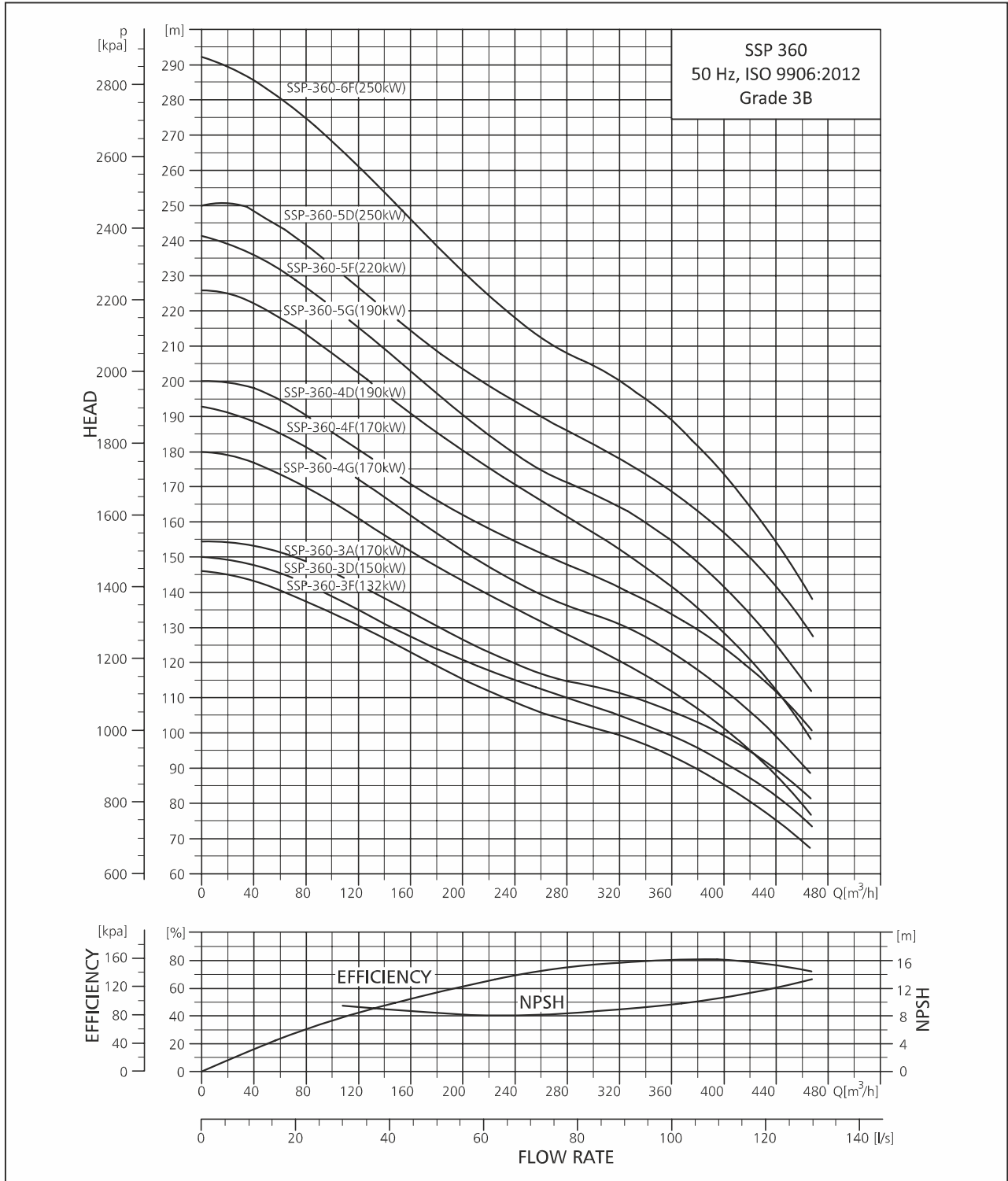

TECHNICAL DATA



SUBMERSIBLE PUMP SSP-360

DIMENSIONS AND WEIGHTS

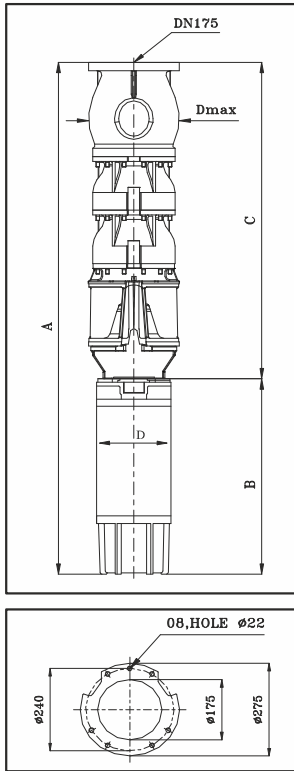

TECHNICAL DATA SSP-360

PUMP TYPE	MOTOR		DIMENSIONS (MM)				NET WEIGHT (KG)
	TYPE	POWER (kW)	C	B	A	D	
SSP360-1L	MATSF8"	37	885	1140	2025	194	296
SSP360-1F	MATSF8"	45	885	1230	2115	194	317
SSP360-1A	MATSF8"	55	885	1340	2225	194	332
SSP360-2N	MATSF8"	63	1065	1470	2535	194	383
SSP360-2L	MATSF8"	75	1065	1560	2625	194	402
SSP360-2F	MATSF8"	93	1065	1740	2805	194	448
SSP360-3L	MATSF10"	110	1245	1529	2774	194	523
SSP360-2A	MATSF10"	110	1065	1529	2594	235	555
SSP360-3L	MATSF10"	110	1245	1529	2774	235	580
SSP360-3G	MATSF10"	130	1245	1659	2904	235	630
SSP360-3F	MATSF10"	130	1245	1659	2904	235	630
SSP360-3D	MATSF10"	150	1245	1769	3014	235	695
SSP360-3A	MATSF10"	150	1245	1769	3014	235	805
SSP360-4G	MATSF10"	170	1425	1919	3344	235	840
SSP360-4F	MATSF10"	170	1425	1919	3344	235	840
SSP360-4D	MATSF10"	185	1425	1919	3344	235	885
SSP360-5G	MATSF10"	185	1605	1919	3524	235	910
SSP360-5F	MOTOR12"	220	1605	1893	3498	286	960
SSP360-5D	MOTOR12"	250	1605	1893	3498	286	1035
SSP360-6F	MOTOR12"	250	1785	1893	3678	286	1060

Dmax (6",8",10" and 12") :290mm

PERFORMANCE TABLE SSP 360

SSP 360					DISCHARGE (Q)															
					m ³ /h		0	40	80	120	160	200	240	280	320	360	400	440		
					l/min.		0	668	1336	2004	2672	3340	4008	4676	5344	6012	6680	7348		
MODEL	MATERIAL				MOTOR RATING		TOTAL HEAD IN (m)													
	6" joining	8" joining	10" joining	12" joining	[kW]	[HP]	41	39	38	36	34	31	30	28	26	23	20	15		
SSP360-1L	9000010998	-	-	-	37	50	41	39	38	36	34	31	30	28	26	23	20	15		
SSP360-1F	-	9000010999	-	-	45	60	47	47	45	42	39	37	35	33	31	28	25	21		
SSP360-1A	-	9000011000	-	-	55	75	51	50	48	47	44	41	38	37	35	33	30	26		
SSP360-2N	-	9000011001	-	-	63	85	74	73	70	67	63	59	56	52	47	42	36	28		
SSP360-2L	-	9000011002	-	-	75	100	82	79	76	73	69	64	60	57	54	49	43	34		
SSP360-2F	-	9000011003	-	-	93	125	96	95	90	85	79	74	70	67	63	59	54	47		
SSP360-2A	-	-	9000011004	-	110	150	102	101	98	93	88	83	78	75	72	68	64	57		
SSP360-3L	-	-	9000011005	-	110	150	123	119	115	109	103	97	91	86	82	75	66	53		
SSP360-3G	-	-	9000011006	-	132	177	133	131	126	119	112	106	100	94	88	82	74	63		
SSP360-3F	-	-	9000011007	-	132	177	143	141	135	127	119	112	106	101	96	70	82	72		
SSP360-3D	-	-	9000011008	-	147	197	147	146	140	132	124	118	113	108	103	97	89	79		
SSP360-3A	-	-	9000011009	-	147	197	153	152	147	140	132	124	118	113	109	104	97	87		
SSP360-4G	-	-	9000011010	-	170	230	178	174	167	159	150	141	133	126	118	110	99	85		
SSP360-4F	-	-	9000011011	-	170	230	190	188	180	169	158	149	141	135	128	120	110	96		
SSP360-4D	-	-	9000011012	-	185	252	196	194	186	176	167	158	150	144	137	130	120	107		
SSP360-5G	-	-	9000011013	-	185	252	221	217	208	197	186	175	166	157	147	137	123	106		
SSP360-5F	-	-	-	9000011014	220	295	238	236	225	212	198	187	177	169	161	151	139	122		
SSP360-5D	-	-	-	9000011015	250	335	246	243	233	221	209	198	189	181	173	163	150	134		
SSP360-6F	-	-	-	9000011016	250	335	286	282	270	253	237	223	212	202	193	182	166	147		

This Performance Table is Approximate as a Performance Curve
 Technical Change without notice

PERFORMANCE CURVE



SUBMERSIBLE PUMP SSP-360

